

MANUAL TRANSAXLE REMOVAL/INSTALLATION [F35M-R]

B3E051501029W03

1. Remove the following parts:

- (1) Battery and battery tray
(See [BATTERY REMOVAL/INSTALLATION \[ZJ, Z6\].](#))
- (2) Air cleaner component
(See [INTAKE-AIR SYSTEM REMOVAL/INSTALLATION \[ZJ, Z6\].](#))
- (3) EGR pipe
(See [EXHAUST SYSTEM REMOVAL/INSTALLATION \[ZJ, Z6\]](#))
- (4) Wheels, tires and splash shields
- (5) Under cover
- (6) Starter
(See [STARTER REMOVAL/INSTALLATION \[ZJ, Z6\].](#))

2. Drain the transaxle oil into a suitable container.

3. Remove in the order indicated in the table.

4. Install in the reverse order of removal.

5. Add the specified amount of specified transaxle oil.

Note

- If the transaxle is overhauled and installed to the vehicle, perform the 'INSPECTION AFTER TRANSAXLE OVERHAUL' and verify that there is no abnormality.
(See [INSPECTION AFTER TRANSAXLE OVERHAUL \[F35M-R\].](#))

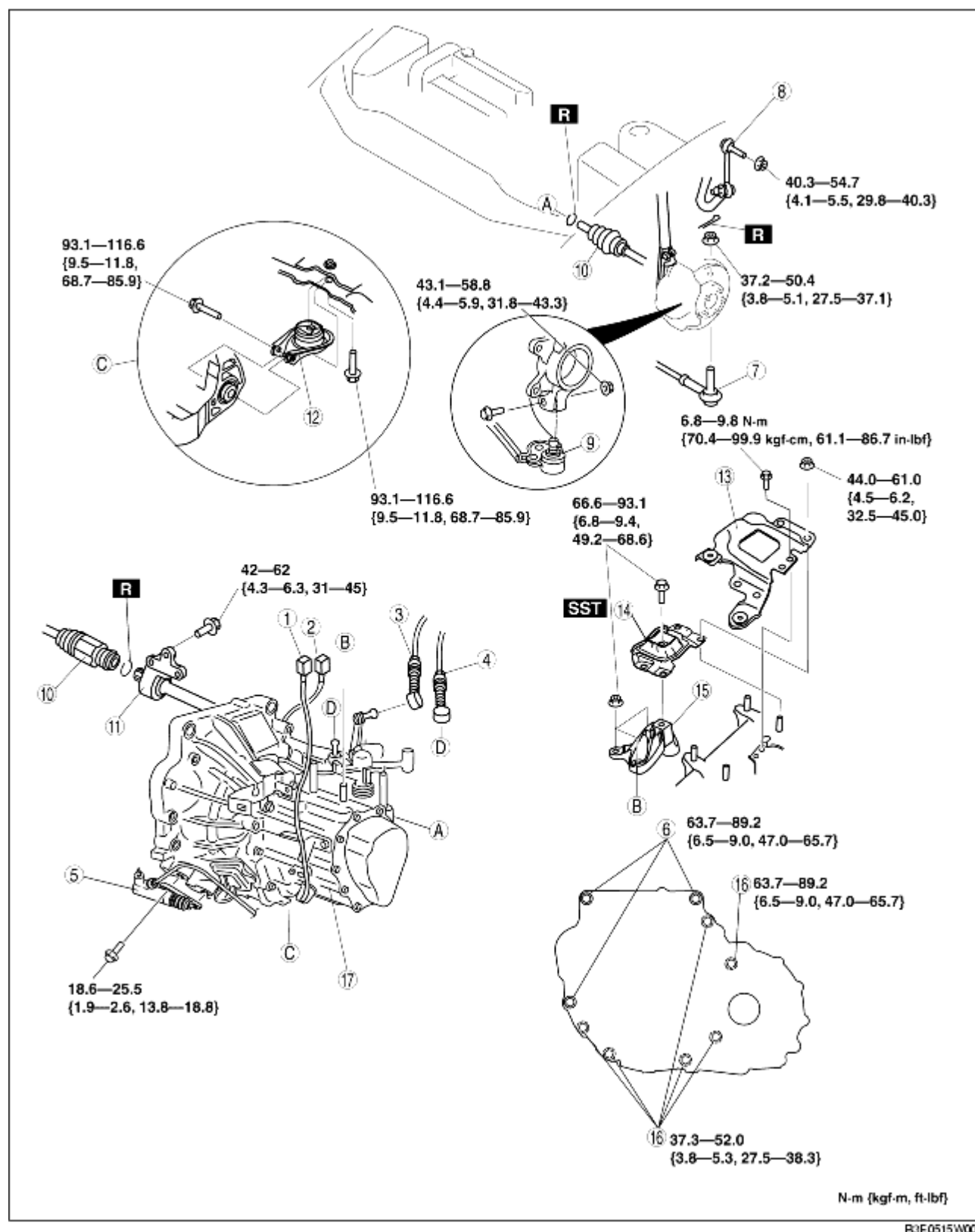

B3E0515W004

1	Back-up light switch connector
2	Neutral switch connector
3	Select cable (See Shift Cable and Select Cable Removal Note.)
	Shift cable

4	(See Shift Cable and Select Cable Removal Note.)
5	Clutch release cylinder
6	Transaxle mounting bolt (upper side)
7	Tie-rod end ball joint (See STEERING GEAR AND LINKAGE REMOVAL/INSTALLATION.)
8	Stabilizer control link
9	Lower arm ball joint
10	Drive shaft (See DRIVE SHAFT REMOVAL/INSTALLATION.)
11	Joint shaft (See JOINT SHAFT REMOVAL/INSTALLATION.)
12	No.1 engine mount rubber (See No.1 Engine Mount and No.4 Engine Mount Bracket Installation Note.)
13	Battery tray bracket
14	No.4 engine mount rubber (See No.1 Engine Mount and No.4 Engine Mount Bracket Installation Note.)
15	No.4 engine mount bracket (See No.1 Engine Mount and No.4 Engine Mount Bracket Installation Note.)
16	Transaxle mounting bolt (lower side)
17	Manual transaxle (See Manual Transaxle Removal Note.) (See Manual Transaxle Installation Note.)

Shift Cable and Select Cable Removal Note

1. Remove the both shift cable end and select cable end using a fastener remover.

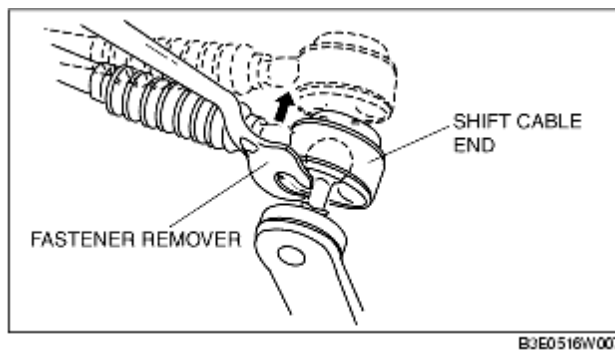

B3E0516W007

No.4 Engine Mount Removal Note

1. Remove the P/S reserve tank and coolant reserve tank with the hose still connected.
2. Using the bolts **part number 99794 1025** or **M10×1.25, length 25 mm {0.98 in}** to install the **SST** to the position shown in the figure.

Caution

- When attaching the SST in the engine rear side, install a suitable nut between the engine and the SST.

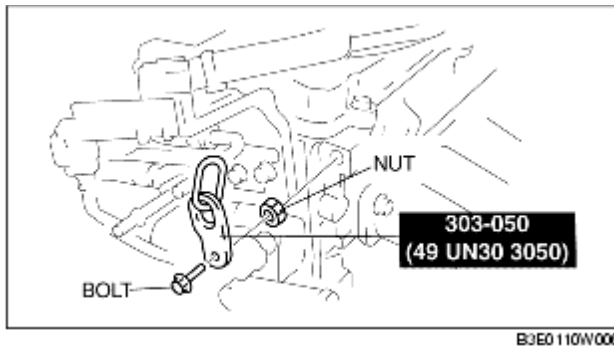

B3E0110W006

Tightening torque

38-51 N·m

{3.9-5.2 kgf·m, 29-37 ft·lbf}

- Insert a wood slab of appropriate size between the front fender panel and upper apron reinforcement.

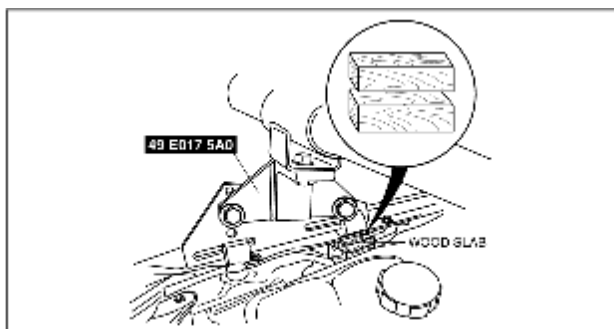

B3E0515W005

Note

- Wood slab height
4SD : approx. 35 mm {1.4 in}
5HB : approx. 60 mm {2.4 in}
- Cut the wood slab into two pieces and insert.

- Support the engine using the SST.

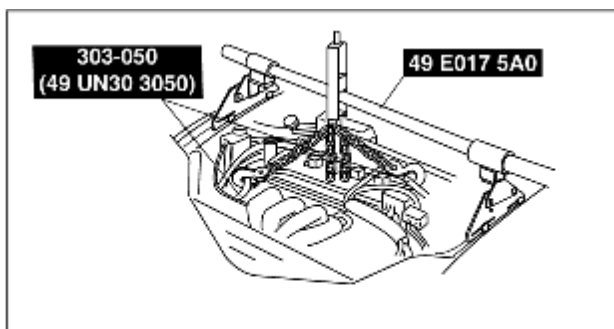

B3E0515W012

Note

- A hoist or small crane can be used in place of the **SST** (49E 017 5A0).

5. Remove the battery tray bracket, No.4 engine mount rubber and bracket.

Manual Transaxle Removal Note

1. Loosen the part marked A and lean the engine toward the transaxle.

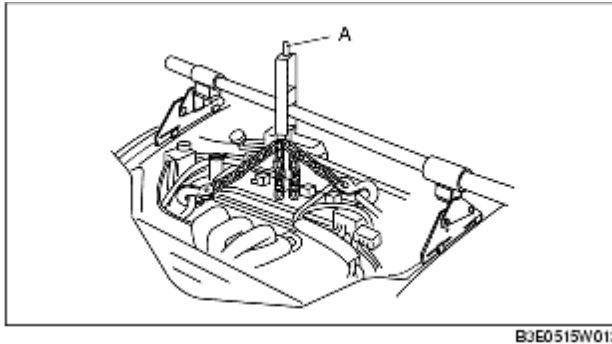

2. Support the transaxle on a jack.

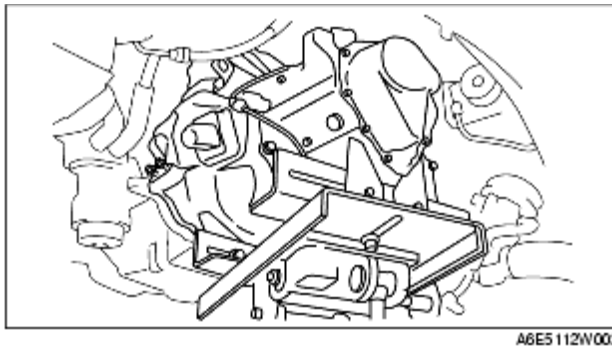

3. Remove the transaxle mounting bolts.

4. Remove the transaxle.

Manual Transaxle Installation Note

1. Set the transaxle on a jack and lift into place.

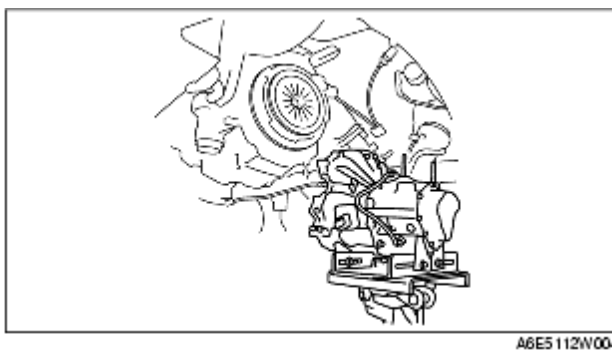

2. Install the transaxle mounting bolts.

3. Tighten the **SST** (49 E017 5A0) so that the engine is located at the specified position.

No.1 Engine Mount and No.4 Engine Mount Bracket Installation Note

1. Install the No.4 engine mount bracket on the transaxle case and tighten nuts.

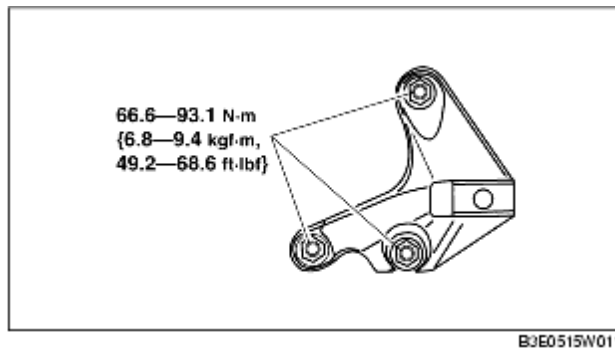

2. Install the No.1 engine mount rubber to the cross member and temporarily tighten bolts.

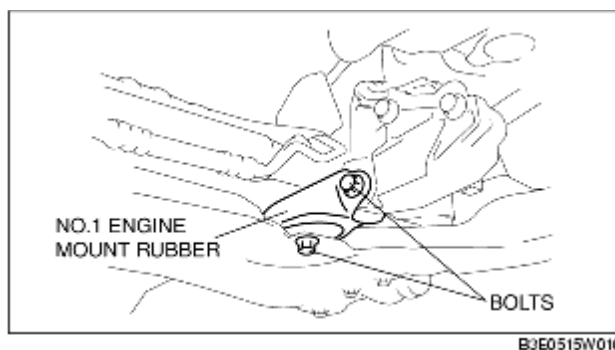

3. Place the No.4 engine mount rubber with the body stud bolts passing through the holes and tighten the bolt in the figure.

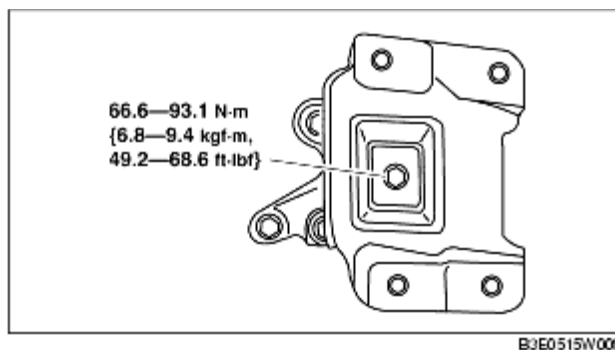

4. Place the battery tray bracket on the No.4 Engine mount rubber with the body stud bolts passing through the holes and tighten nuts in the figure.

5. Fully tighten the bolts.

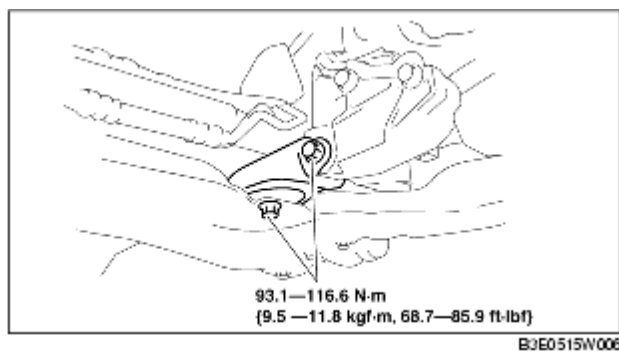

6. Remove the **SSTs**.